

# Importing Computer Clients from a File

You can import a "tab-delimited" text file (not a CSV file).

See [Placeholders](#) for more workflow information. Can be useful for

- [Network Imaging Guide](#)
- [Device Enrollment Program \(DEP\)](#)
- [Enrolling Mobile Devices into FileWave](#)
- [Working with FileWave Clients](#)

The import location is in the Create New Client pane:

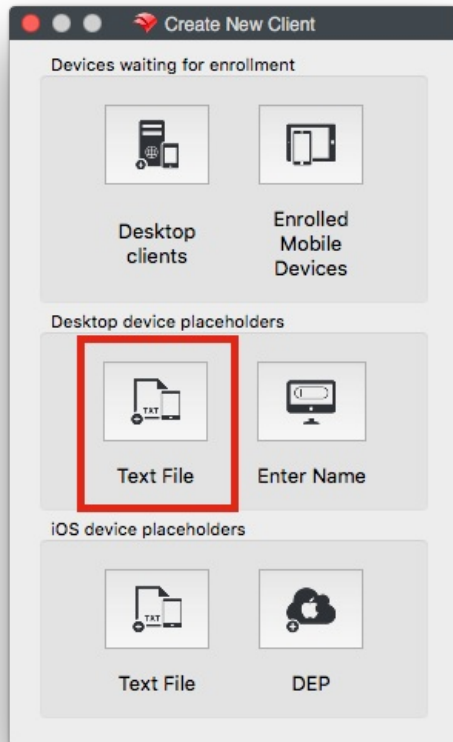

The new format looks like this:

```
Client Name <tab> Comment <tab> Serial or MAC
```

- Name is mandatory
- Comment is optional
- Serial or MAC is optional if you are going to be adding clients that are already named later; otherwise, you must provide either a serial number or MAC address.

MAC address formats can have colons (:) between octets. For serial numbers, only capital letters (A-Z) and ordinal numbers (0-9) are allowed. Create the text file using a text editor that can save the file in plain text format with Unix or Windows line endings.

🔄Revision #4

★Created 12 July 2023 18:55:11 by Josh Levitsky

✎Updated 13 September 2024 14:09:28 by Josh Levitsky